



VIDA 307 Professional seamless video processor and scaler



Features

- Seamless switching between any input
- Horizontal & Vertical scaling
- Configurable PIP size, position, source
- Up to 3840x640, 2304x1152/60Hz out
- On board EDID management
- Synchronized audio output
- User setting save and loading
- Multiple splicing function
- Text overlay function
- Digital and analog input
- Frame synchronization
- Optional SDI input / loop-out
- Optional timer switching



Seamless switching

Switch between in any input without black frame



Configurable PIP

The size and position are configurable to meet the requirement of different projects.

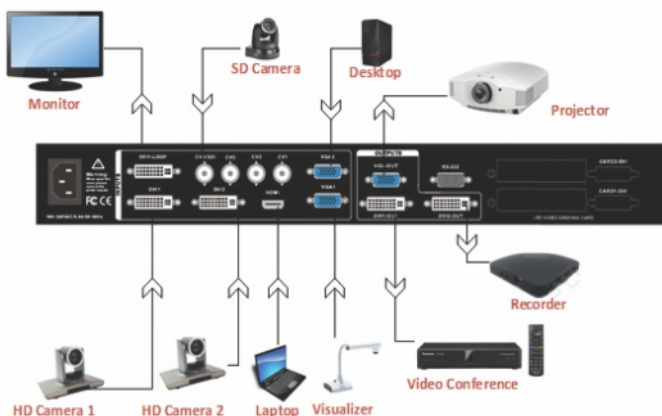

Part/Full screen display

The scaler could cut particular portion of source to display as a full screen view. The area is adjustable in the menu.

Multiple cascading splice

Several units can be used together at the same time to achieve a large screen. Each unit's output could be upto 2.65 megapixel.

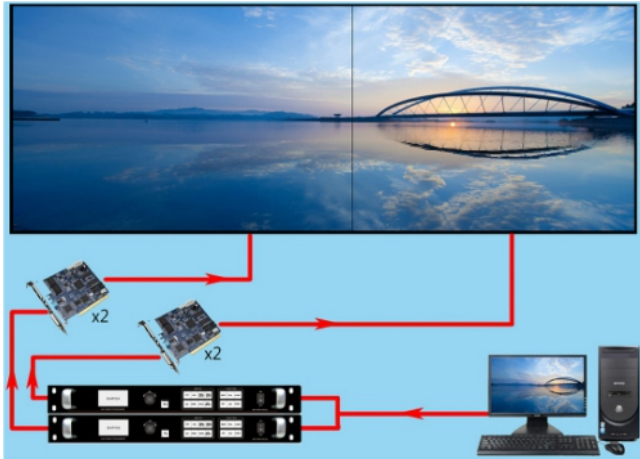

Text Overlay

The text or logo could be overlaid on the video or picture. The background could be deleted by the scaler.



Connectivity Diagram

Support multiple media equipment.

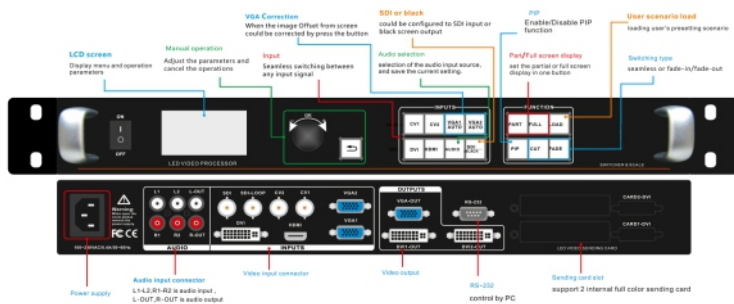
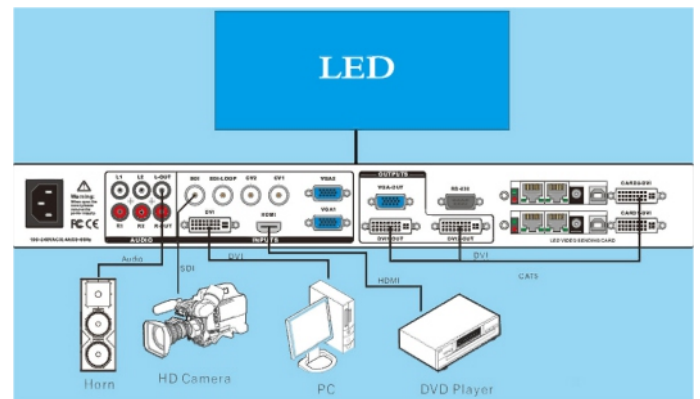

Specifications

Item	Type	Number	Connector	Standard	Resolution
INPUT	CVBS	2	BNC	PAL/NTSC	480i, 576i
	VGA	2	DB15	VESA	1920x1200
	DVI-I	1	DVI-I	DVI1.0, VESA	1920x1200, 1080P
	HDMI	1	HDMI-A	HDMI1.3, VESA	1920x1200, 1080P
OUTPUT	SDI	1	BNC	SDI-SMPTE 259M-C HDSMI-SMPTE 292M SMPTE 274M/296M SMPTE 424M/425M	1080P 60/50/30/25/24 720P 60/50/25/24 1080i 1035i 625/525 line
	VGA	1	DB15	VESA	1024x768@60Hz/75Hz 1536x1536@60Hz 1280x1024@60Hz/75Hz 1600x1200@60Hz 1920x1080@50Hz/60Hz 1366x768@60Hz 1440x900@60Hz 2048x1152@60Hz 2304x1152@60Hz 2560x816@60Hz 3840x640@60Hz
Power	Power supply			100VAC - 240VAC 50/60Hz	
	Consumption			18W	
Environment	Working temperature			0-450C	
	Working humidity			10% - 90%	
Physical	Gross weight			3.2KG	
	Net weight			5.0 KG	
	Product size (mm)			440 x 56 x 253	
	Package size (mm)			515 x 110 x 355	